

InfiniSpring® –Acoustic Wall Tie AWT250NN



Product Description	
Connection 1	Nail plate
Connection 2	Nail plate
Dimensions	W250, H120, T8 (mm)
Material	Steel
Yield strength (EN14195)	Min. 650 MPa
Corrosion protection	Zinc
Natural Frequency range	8.5 – 12.3 Hz
Operating temperature range	-40 - +200 °C
Reaction to fire (EN14195)	Class A1
Durability (EN14195)	Class B
Environmental impact (EN14195)	No

DESCRIPTION

Acoustic wall tie for resiliently installed gypsum board walls. Fastened using nail plates. Very high noise and vibration isolation performance.

INSTALLATION

1. Define acoustic wall tie installation heights using below table.
2. Connect AWT250NN wall ties from the nail plates to both vertical studs with suitable method.
3. Assemble gypsum board wall normally using manufacturer’s instructions.

Installation height example using below table:

- STUD SPACING k600
- WALL HEIGHT 3 METERS
- 2 LAYERS OF GYPSUM BOARDS, WEIGHT 24 KG/M2
- ➔ EACH STUD SUPPORTED FROM THE TOP AND EVERY SECOND FROM THE HALF HEIGHT.
(First row in the table below)

Acoustic wall tie installation heights, stud spacing k600 example			
Gypsum board [pcs]	Weight [kg/m2]	Wall height [mm]	Installation heights (*)
~2-3	20-35	max 3750	From top (100%) + 1/2 (50%)
~3-4	35-40	max 3750	From top (100 %) + 1/2 (100%)
~2-3	20-35	3750-5000	From top (100%) + 2/3 (100%) + 1/3 (50%)
~3-4	35-40	3750-5000	From top (100%) + 2/3 (100%) + 1/3 (100%)
~2-3	20-35	5000-6250	From top (100%) + 3/4 (100%) + 2/4 (100%) 1/4 (50%)
~3-4	35-40	5000-6250	From top (100%) + 3/4 (100%) + 2/4 (100%) 1/4 (100%)

*Example ½ (50%): Every second stud supported from the half height

NOTE

Acoustic wall ties shall not carry the weight of the resilient gypsum board wall, but the gypsum board wall weight shall be carried resiliently. To guarantee acoustic performance of the gypsum board wall the wall as a whole need to be fully resilient and fully sealed.

ACOUSTIC PERFORMANCE



RECYCLING

Product is 100 percent steel and can be recycled together with other steel scrap.

MANUFACTURER

Labrys Oy / InfiniSpring

Uuspihlajantie 19

66370 Närviöjoki

Finland

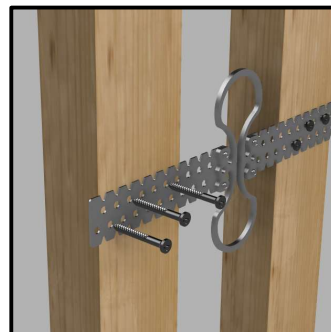
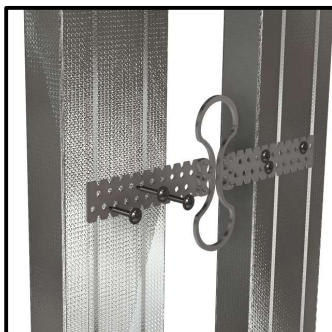

Please check more information from AWT250NN Installation Instruction